

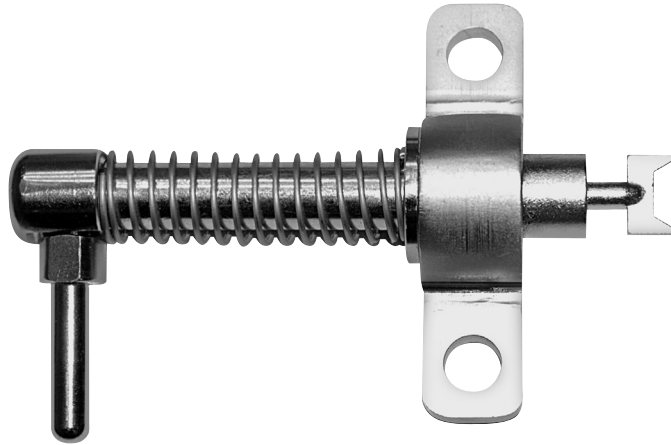

# SPECIFICATION DATA SHEET

## TYPE DM - LATCH BOLT OPTIONS

WWW.KIRKKEY.COM



### DM Latch Bolt with Spring & Mounting Bracket (Part # S42955A00)

The optional Type DM latch bolt with spring and mounting bracket offers mounting alternatives for the Type DM Interlock. The mounting bracket is designed to hold the latch bolt in close proximity to the DM lock body. After inserting and turning the key, the latch bolt can be rotated 1/4 turn to be released from the lock – thereby trapping the key.

A sliding door or gate is a good application for this style of latch bolt.

All components of the S42955A00 DM latch bolt are made from electropolished 316 stainless steel.

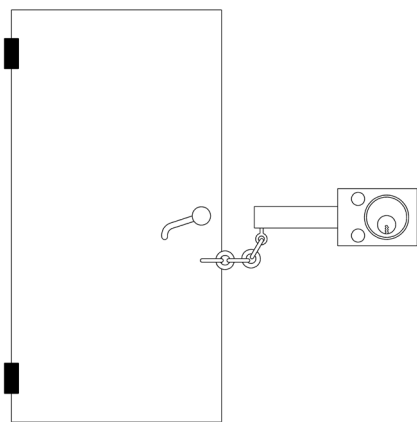

Door or Hatch

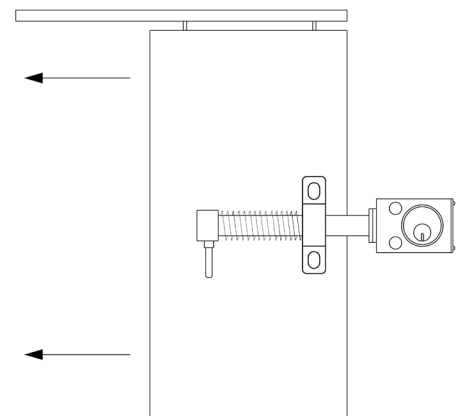

Sliding Door or Gate

# LATCH BOLT DRAWING

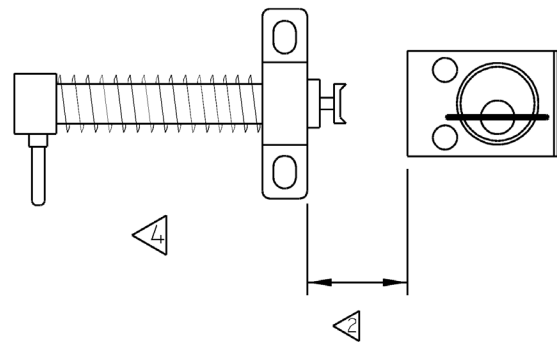
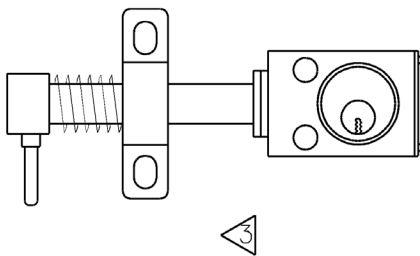
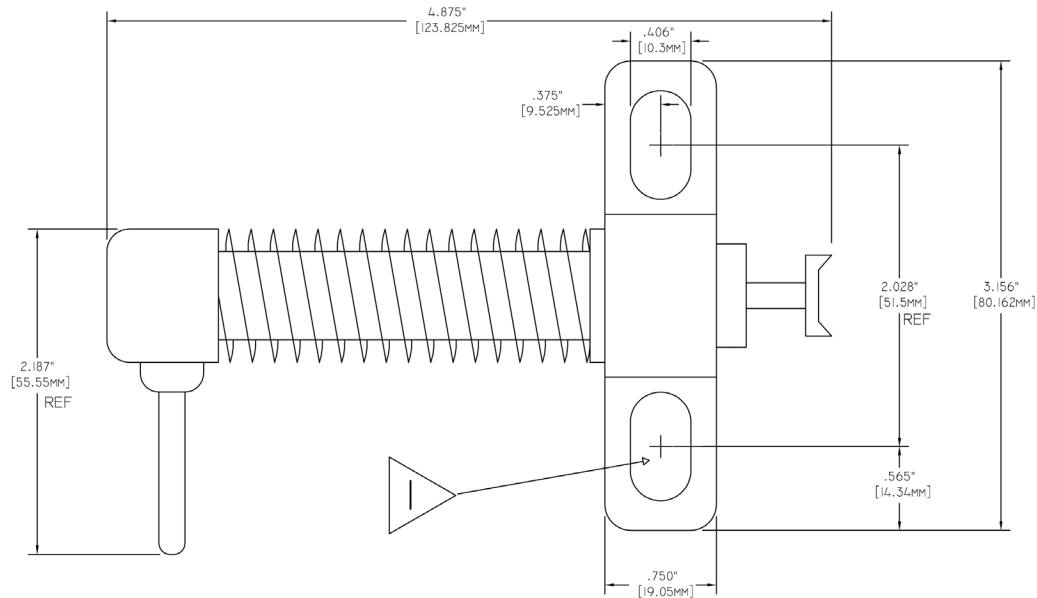
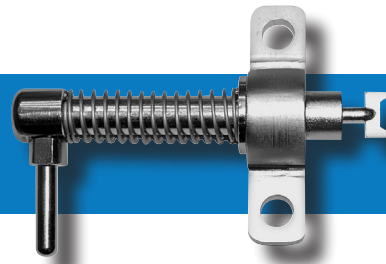

## NOTES:

- 1) 0.406" (10.3mm) x .75" (19.05mm) slotted holes for mounting bolts (2 holes).
- 2) Recommended Spacing: 13/16" (20.64mm) min, 1 1/4" (31.75mm) max.
- 3) Latched - key released.
- 4) Unlatched - key trapped.

# TYPE DM LATCH BOLT ORDERING GUIDE

To order the latch bolt with spring and mounting bracket just specify the part number with your Type DM interlocks.

	1	2	3	4	5	6	7	8	9
Part Number	S	4	2	9	5	5	A	0	0